



**CUSTOMER:** \_\_\_\_\_ **DATE:** \_\_\_\_\_

**CONTACT:** \_\_\_\_\_ **PHONE:** \_\_\_\_\_ **FAX:** \_\_\_\_\_

### 1) APPLICATION

- INDOOR    OUTDOOR    MARINE ENVIRONMENT    MOBILE EQUIPMENT    OVERHEAD CRANE/HOISTING    CRANE CHAIR
- PORTABLE EQUIPMENT    FOOT PEDAL    OTHER \_\_\_\_\_

### 2) CONTROLLER SIZE & DURABILITY

- MINIATURE: V10 H100 H7 V14 V20 S14    MEDIUM: V11 V8 D8
- SMALL: V5 VV5 S2 S21 S22 S23 S24 N6    LARGE: V3 V6 VV6 D64 DD64 K2

### 3) CONTROLLER FUNCTIONS

SINGLE AXIS (PICK 1 OF 3 ITEMS BELOW)

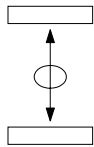

STANDARD BI-DIRECTIONAL

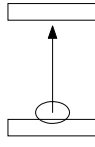

FULL TRAVEL UNI-DIRECTIONAL

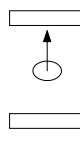

CENTER TO END UNI-DIRECTIONAL

DUAL AXIS

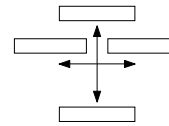

MULTI AXIS

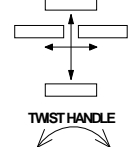

TWIST HANDLE

### 4) SWITCH SPECIFICATIONS

LEFT HAND MOUNTING

- VOLTAGE \_\_\_\_\_ AC/DC    CURRENT \_\_\_\_\_ AMPS.  
 DIRECTION 1&2    DIRECTION 3&4  
 NUMBER OF CONTACTS \_\_\_\_\_    NUMBER OF CONTACTS \_\_\_\_\_  
 STEPLESS OR STEPS \_\_\_\_\_    STEPLESS OR STEPS \_\_\_\_\_
- SPRING RETURN    SPRING RETURN
  - FRICTION BRAKE    FRICTION BRAKE
  - POTENTIOMETER \_\_\_\_\_    POTENTIOMETER \_\_\_\_\_
  - ELECTRONICS    ELECTRONICS

RIGHT HAND MOUNTING

- VOLTAGE \_\_\_\_\_ AC/DC    CURRENT \_\_\_\_\_ AMPS.  
 DIRECTION 5&6    DIRECTION 7&8  
 NUMBER OF CONTACTS \_\_\_\_\_    NUMBER OF CONTACTS \_\_\_\_\_  
 STEPLESS OR STEPS \_\_\_\_\_    STEPLESS OR STEPS \_\_\_\_\_
- SPRING RETURN    SPRING RETURN
  - FRICTION BRAKE    FRICTION BRAKE
  - POTENTIOMETER \_\_\_\_\_    POTENTIOMETER \_\_\_\_\_
  - ELECTRONICS    ELECTRONICS

### 5) ELECTRONICS

#### A) VALVE SPECIFICATIONS

VALVE MANUFACTURE \_\_\_\_\_ MODEL NUMBER \_\_\_\_\_

SUPPLY VOLTS: \_\_\_\_\_ VDC    COIL RESISTANCE: \_\_\_\_\_ OHMS    THRESHOLD: \_\_\_\_\_ mA    MAX. OUTPUT \_\_\_\_\_ mA

SINGLE COIL    DUAL COIL    FLOW CONTROL    SWITCHES FOR DIRECTIONAL VALVES    PWM FREQUENCY: \_\_\_\_\_ Hz

#### B) SIGNAL OUTPUTS

SUPPLY VOLTS: \_\_\_\_\_ VDC     4-20mA    0-20mA    0-10V    -10V to +10V    OTHER \_\_\_\_\_

#### C) OPTIONS FOR BOTH

SINGLE MAX. (A ADJ.)    DUAL MAX. (A & B ADJ.)    DUAL RANGE \_\_\_\_\_ mA    RAMP TIME \_\_\_\_\_ SEC.

### 6) HANDLE TYPE

- STANDARD KNOB    MECHANICAL INTERLOCK    PUSHBUTTON DEADMAN    PUSH DEADMAN    PULL DEADMAN
- PALM HANDLE \_\_\_\_\_

### 7) NAMEPLATE SPECIFICATIONS

STANDARD NAMEPLATE \_\_\_\_\_     SPECIAL NAMEPLATE (ATTACH LAYOUT DRAWING OR SPECIFICATIONS)

### 8) ENCLOSURE

- GENERAL PURPOSE    WEATHERPROOF    CORROSIVE RESISTANT (PLASTIC)    PORTABLE CONSOLES
- ENCLOSURE DIMENSIONS L= \_\_\_\_\_ W= \_\_\_\_\_ H= \_\_\_\_\_     TS1    TS2

### 9) NOTES

---

---

---

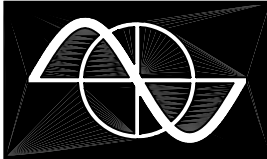

THE H7 SWITCH IS DESIGNED FOR RADIO AND PORTABLE CONTROLS. THEY ARE SMALL, LIGHTWEIGHT AND ARE SOLID IN DESIGN. IT IS BUILT FOR 3 MILLION OPERATIONS. DEGREE OF PROTECTION: IP54

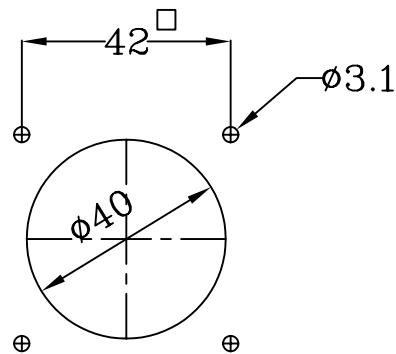
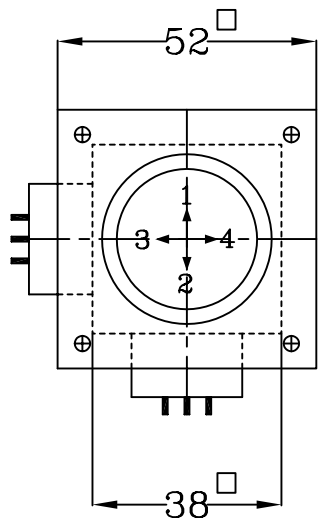
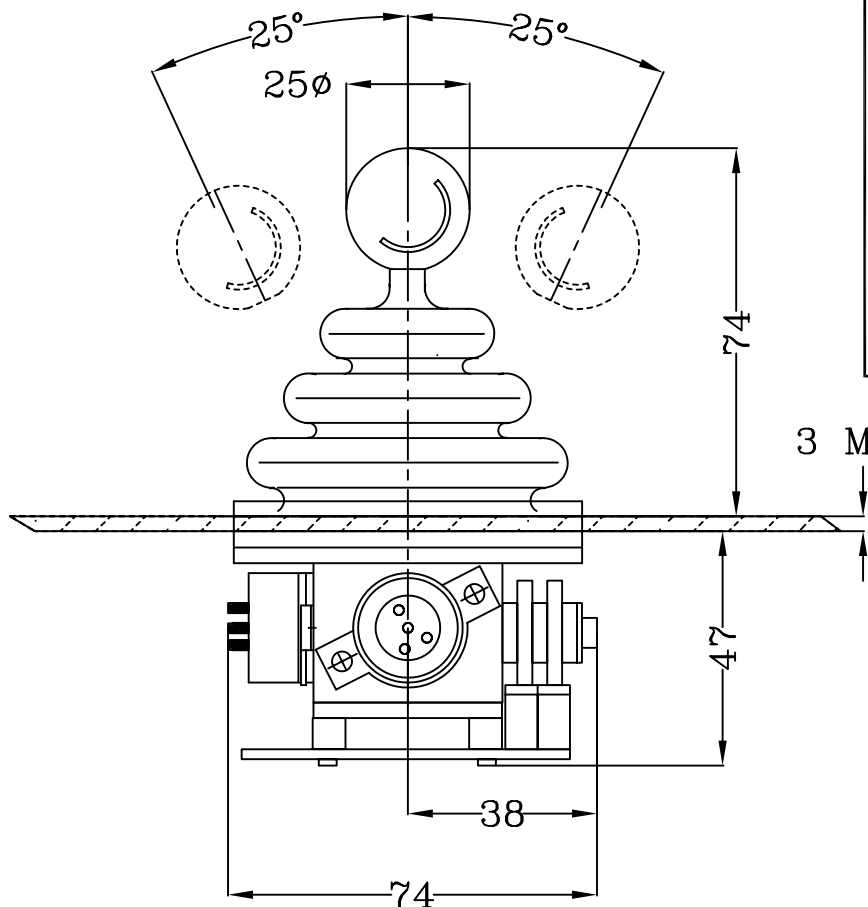

PANEL CUT OUT

H7	H7-BASIC MASTER SWITCH
	X-STANDARD HANDLE
	B-PUSH BUTTON IN HANDLE
	1-SWITCHING GATE #1 I
	2-SWITCHING GATE #2 +
	3-SWITCHING GATE #3 □
	4-SPECIAL SWITCHING GATE
	CONTACT ARR. DIR. 1-2
	A-Z-FROM SHEET 20.2.1
	O-SPECIAL CONTACT ARR.
	X-IF NOT REQUIRED
	Z-SPRING RETURN
	I-BRAKE ADJUSTABLE
	X-IF NOT REQUIRED
	P-POTENTIOMETER SEE SECT. 6
	X-IF NOT REQUIRED
	CONTACT ARR. DIR. 3-4
	A-Z-FROM SHEET 20.2.1
	O-SPECIAL CONTACT ARR.
	X-IF NOT REQUIRED
	Z-SPRING RETURN
	I-BRAKE ADJUSTABLE
	X-IF NOT REQUIRED
	P-POTENTIOMETER SEE SECT. 6
	X-IF NOT REQUIRED
	1-M-STANDARD NAMEPLATE. SECT. 20.1
	X-IF NOT REQUIRED
	O-SPECIAL NAMEPLATE MARK IN CHART
	G-GENERAL PURPOSE ENCL.
	W-WEATHERPROOF ENCL.
	O-OPEN TYPE SWITCH

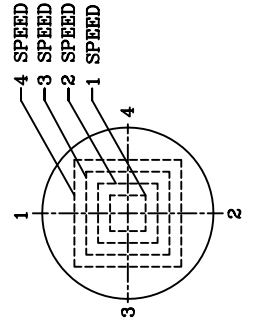

MARK IN SPECIAL SWITCHING GATE ONLY

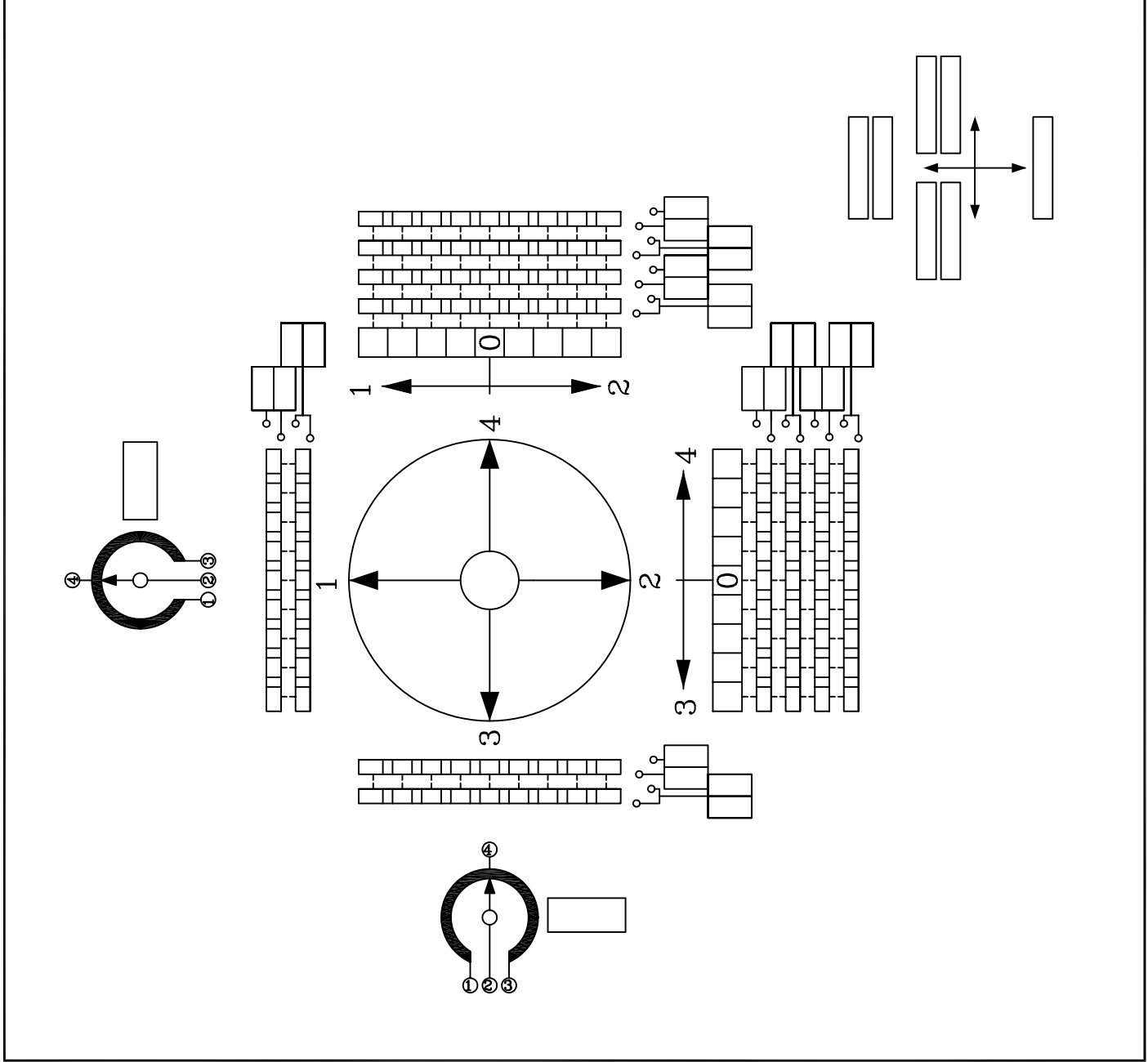

GESSMANN <b>H7 MASTER SWITCH</b>		JOB #
DATE:	FROM:	
NAME:		